

Design Features

- Available in wafer body style. Suitable for installation between FF or RF flanges.
- Valve sizes 6" and larger are complete with a valve lifting lug tap.
- Teflon thrust washers are standard.
- Available with resilient (Buna-N or EPDM) seats.
- Seat design lifts then swings discs to minimize seat wear.
- Body meets ASME B16.1, space API 594.
- Testing is performed in accordance with API 598.
- All valves are equipped with independent springs that optimize the closing rates of each valve plate, while minimizing spring stress.

Parts List and Standard Materials

Part	Description	Specifications
1	Body	A126-B Cast Iron
2	Discs	Aluminum Bronze B148 C954 or 316 SS A351-CF8M
3	Seat	Buna-N or EPDM
4	Hinge Pin	316 SS
5	Spring	316 SS
6	Thrust Washers	Teflon / Phenolic
7	Stop Pin	316 SS
8	Hinge Pin Retainer ¹	A126-B
9	Stop Pin Retainer ¹	A126-B

Upper Pressure Limits (Non-Shock)

Valve Size	M.A.W.P psig (Bars)
2" - 12" (50-300mm)	200 (13.79)
14" - 48" (350-1200mm)	150 (10.34)

Lower Temperature Limits

Body/Seat Material	Lower Limit °F (°C)
A126-B	-20° (-28.9°)
Buna-N / EPDM	-13° (-25°)

- Notes:**
1. Materials of equivalent strength may be substituted at manufacturer's option.
 2. See page 6 for part identification.

Pressure Temperature Chart (In Accordance with ASME B16.1, A126-B)

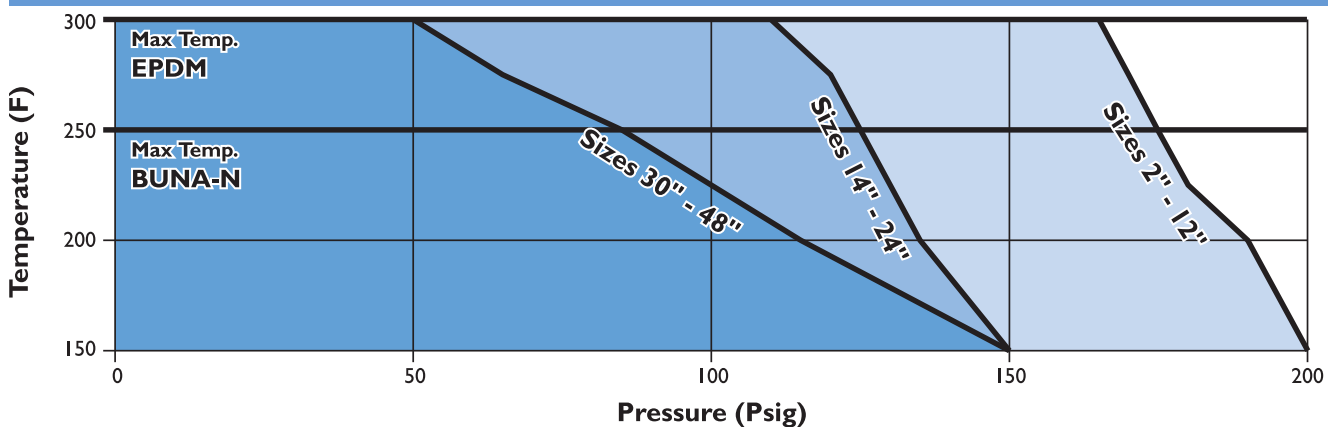

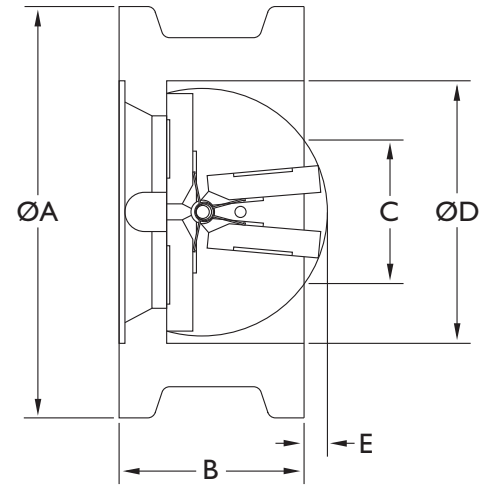
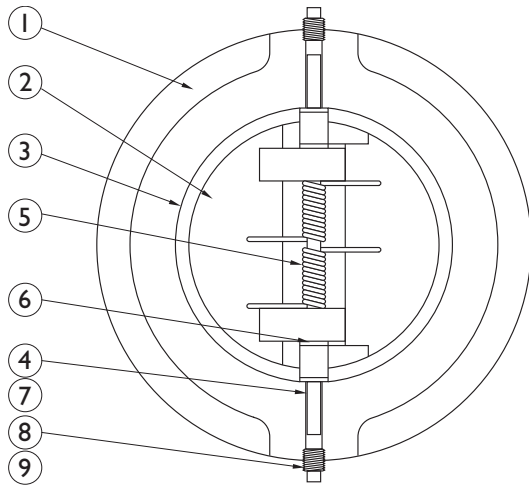

Dimensional Data (Class 125)						Stud Selection			
Size ¹ in. (mm)	ØA in. (mm)	B in. (mm)	C ² in. (mm)	ØD in. (mm)	E in. (mm)	Qty.	Dia. in. (mm)	Length in. (mm)	Weight lb. (kg)
2 (50)	4.13 (105)	2.13 (54)	2.00 (51)	2.38 (60)	0.13 (3)	4	0.63 (16)	5.50 (140)	4 (1.8)
2.5 (65)	4.88 (124)	2.13 (54)	2.50 (64)	2.88 (73)	0.50 (13)	4	0.63 (16)	6.00 (152)	5.5 (2.5)
3 (80)	5.38 (137)	2.25 (57)	3.00 (76)	3.50 (89)	0.63 (16)	4	0.63 (16)	6.25 (159)	7.5 (3.4)
4 (100)	6.88 (175)	2.50 (64)	4.00 (102)	4.50 (114)	1.00 (25)	8	0.63 (16)	6.25 (159)	13.5 (6.1)
5 (125)	7.75 (197)	2.75 (70)	5.00 (127)	5.50 (140)	1.25 (32)	8	0.75 (19)	7 (184)	17.5 (7.9)
6 (150)	8.75 (222)	3.00 (76)	6.00 (152)	6.63 (168)	1.63 (41)	8	0.75 (19)	8.00 (203)	26.5 (12.0)
8 (200)	11.00 (279)	3.75 (95)	8.00 (203)	8.63 (219)	2.38 (60)	8	0.75 (19)	9.50 (241)	50 (22.7)
10 (250)	13.38 (340)	4.25 (108)	10.00 (254)	10.75 (273)	3.00 (76)	12	0.88 (22)	10.50 (267)	70 (31.8)
12 (300)	16.13 (410)	5.63 (143)	12.00 (305)	12.75 (324)	3.88 (99)	12	0.88 (22)	12.25 (311)	110 (49.9)
14 (350)	17.75 (451)	7.25 (184)	12.50 (318)	14.00 (356)	4.00 (102)	12	1.00 (25)	13.00 (330)	170 (77.1)
16 (400)	20.25 (514)	7.50 (191)	15.00 (381)	16.00 (406)	5.25 (133)	16	1.00 (25)	13.50 (343)	225 (102.1)
18 (450)	21.61 (549)	8.00 (203)	17.00 (432)	18.00 (457)	6.00 (152)	16	1.13 (29)	14.50 (368)	280 (127.0)
20 (500)	23.86 (606)	8.38 (213)	19.00 (483)	20.00 (508)	6.88 (175)	20	1.13 (29)	15.25 (387)	390 (176.9)
24 (600)	28.25 (718)	8.75 (222)	22.75 (578)	24.00 (610)	8.25 (210)	20	1.25 (32)	16.25 (413)	590 (267.6)

- Notes:**
1. Dimensions are in accordance with API 594 except face to face dimensions of 2.5" thru 12" valves.
 2. Minimum bore diameter of companion flanges.
 3. Larger sizes available upon request.

- General:**
1. For pressure loss information please see page 14.
 2. For ordering information please see page 18.
 3. Dimensions are subject to change. Contact factory for certified prints when required.