

### Design Features

- Available in wafer body style. Suitable for installation between RF flanges.
- May be installed between ANSI Class 150/300 flanges (Sizes 6" and smaller only).
- Standard metal to metal seating. Optional resilient seats.
- Body meets ASME B16.5 and ASME B16.34.
- Testing is performed in accordance with API 598.

### Upper Pressure Limits (Non-Shock)

Valve Size - in. (mm)	Body Material	M.A.W.P. - psig (Bars)
2" - 4" (50 - 100mm)	A216-WCB	740 (51.02)
	A351-CF8M	720 (49.64)
6" - 12" (150 - 250mm)	A216-WCB	285 (19.65)
	A351-CF8M	275 (18.96)

### Parts List and Standard Materials

Part	Description	Carbon Steel	Stainless Steel
1	Body	A216-WCB	A351-CF8M 316 SS
2	Plug	A351-CF8M 316 SS	A351-CF8M 316 SS
3	Seat <sup>2</sup>	A351-CF8M 316 SS	A351-CF8M 316 SS
4	Spring <sup>1</sup>	Type 316 SS	Type 316 SS
5	Bushing <sup>1</sup>	Type 316 SS	Type 316 SS
6	Seat Seal	Buna-N	Buna-N

### Lower Temperature Limits

Body/Seat Material	Lower Limit °F (°C)
A126-WCB, A351-CF8M	-20° (-28.9°)
Buna-N, EPDM, Viton	-13° (-25°)

- Notes:**
1. Materials of equivalent strength may be substituted at manufacturer's option.
  2. Resilient seats are available. Contact factory.

### Pressure Temperature Chart (In Accordance with ASME B16.34, A126-WCB)

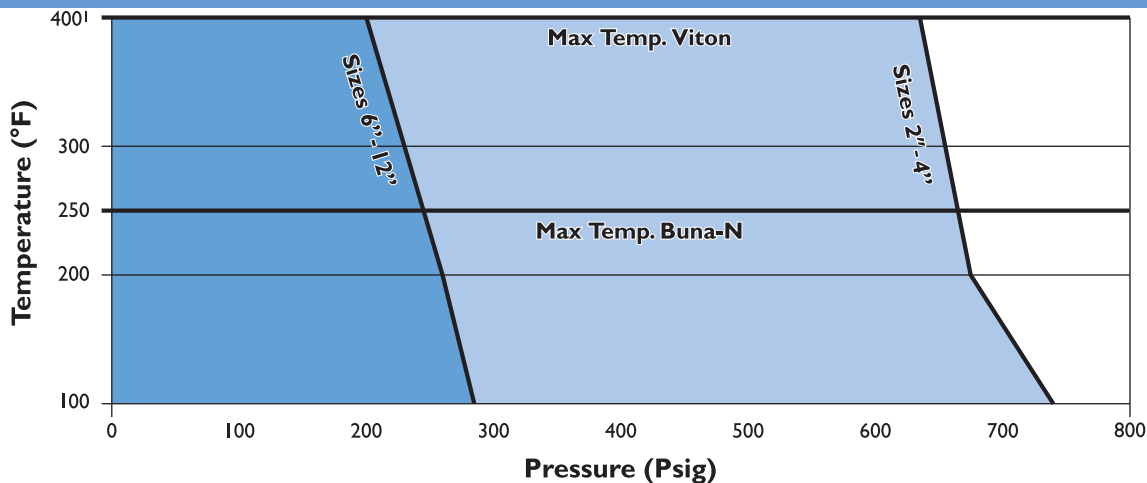

- Notes:**
1. Maximum operating temperature limited by seat seal material.
  2. Valves recommended for liquid service only.

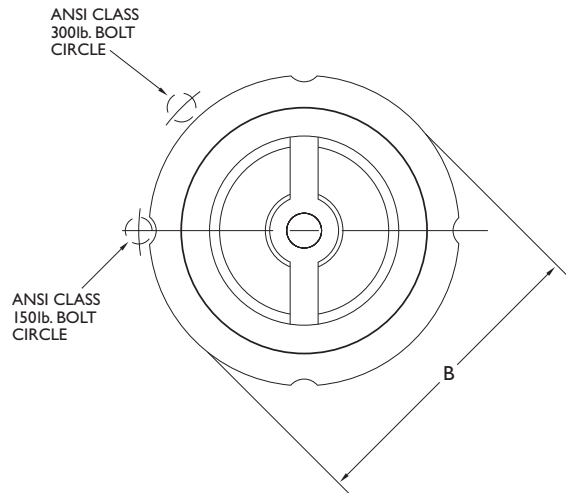
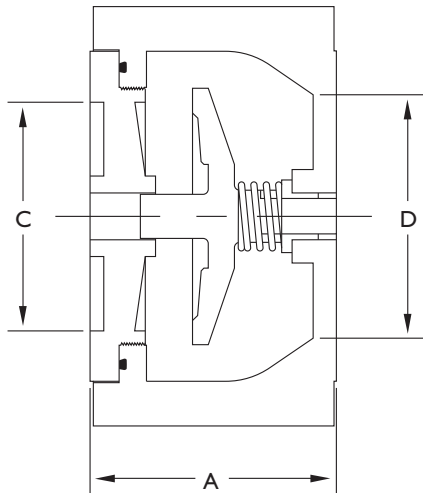

Dimensional Data (Class 125)					Stud Selection						
Size in. (mm)	A in. (mm)	B in. (mm)	C in. (mm)	D in. (mm)	Qty. 150lb.	Qty. 300lb.	Dia. 150lb. in. (mm)	Dia. 300lb. in. (mm)	Length in. (mm)	Weight lb. (kg)	Cv
2 (50)	2.63 (67)	4.25 (108)	2.00 (51)	2.38 (60)	4	8	0.63 (16)	0.63 (16)	6.00 (152)	5 (2.3)	57
2.5 (65)	2.88 (73)	5.00 (127)	2.75 (70)	2.88 (60)	4	8	0.63 (16)	0.75 (19)	6.75 (171)	8 (3.6)	87
3 (80)	3.13 (80)	5.75 (146)	3.25 (83)	3.50 (89)	4	8	0.63 (16)	0.75 (19)	7.25 (184)	10 (4.5)	127
4 (100)	4.00 (102)	7.00 (178)	4.00 (102)	4.50 (114)	8	8	0.63 (16)	0.75 (19)	7.75 (197)	17 (7.7)	228
5 (125)	4.63 (118)	8.38 (213)	5.00 (127)	5.50 (140)	8	8	0.75 (19)	0.75 (19)	9.00 (229)	27 (12.3)	357
6 (150)	5.50 (140)	9.75 (248)	6.25 (159)	6.63 (168)	8	12	0.75 (19)	0.75 (19)	10.50 (267)	40 (18.2)	432
8 (200)	6.50 (165)	12.00 (305)	8.38 (213)	8.63 (219)	8	-	0.75 (19)	-	12.25 (311)	90 (40.9)	768
10 (250)	8.25 (210)	16.00 (406)	10.00 (254)	10.38 (264)	12	-	0.88 (22)	-	14.50 (368)	160 (72.6)	1240
12 (300)	11.25 (286)	19.00 (483)	11.75 (298)	12.50 (318)	24	-	0.88 (22)	-	6.50 (165)	340 (154.4)	1740

- Notes:**
- Sizes 2" thru 6" can be installed between both ANSI Class 150lb. and ANSI Class 300lb. flanges.
  - Sizes 8" and larger can only be installed between ANSI Class 150lb. flanges.
  - Soft seats are available. Please consult factory.
  - All sizes have Buna-N (-13°F to 250°F) body O-Ring Seals. Contact factory for other materials.

- General:**
- For pressure loss information please see page 33.
  - For ordering information please see page 38.
  - Dimensions are subject to change. Contact factory for certified prints when required.