

Design Features:

- Standard sizes from 2" - 24".
- Available with RF or RTJ flanged (ASME B16.5), Buttweld (ASME B16.9) or grooved end connections.
- Standard thru bolt or grooved cover design.
- Custom modifications are available.
- May be installed in horizontal or vertical pipelines.
- All welders are qualified to ASME Section IX.
- Strainers designed to meet the requirements of ASME B31.1 and/or ASME B31.3.
- 304 SS perforated screens are standard.
- Drains connections are standard and are furnished with plug.
- Vents, differentials and special covers are optional.

Parts List and Standard Materials (Flanged End)

Part	Carbon Steel	Stainless Steel ¹
Shell & Nozzles	A53 E/B / A106-B	A312
Reinforcement Pads ²	A516-70	A240
Flanges	A105	A182
Coupling/threadolet:	A105	A182
Plug	A105	A182
Screen Retainer Ring	A36	A240
Screen ³	304 SS	304 SS
Gasket ³	304 SS Spiral Wound	304 SS Spiral Wound
Stud	A193-B7	A193-B8-1
Nut	A194-2H	A194-8

- Notes:** 1. 304 SS strainers use 304 grade material. 316 SS strainers use 316 grade material. Dual rated material may be used.
2. When required and when used.
3. Recommended Spares.

Parts List and Standard Materials (Grooved End)

Part	Stainless Steel
Shell & Nozzles	A312-304
Flanges	A36 Zinc Plated
Plug	B584 Brass
Cover	Sizes 2 1/2" - 5" & 12": Ductile Iron Sizes 6" - 10": 304 SS
Screen ¹	304 SS
Gasket ¹	EPDM
Bolts	B633
Nuts	B633

- Notes:** 1. Recommended Spares.
2. Lead-free construction complies with California Prop. 65 and proposed Federal Government lead-free standards.
3. Single, two-bolt, grooved style cover provides quick and easy access to screen.

Upper Pressure Limits (Non-Shock) and Lower Temperature Limits (Unless otherwise specified)

IFC Model	Body Material	Size Range in. (mm)	Maximum Design Pressure psig (Bars) ¹	Low Temperature Limit - M.D.M.T. - °F (°C)
Y125FSBW	Carbon Steel	2" - 12" (50mm - 300mm)	200 (13.79) ²	-20 (-28.9)
		14" - 24" (350mm - 600mm)	150 (10.34) ²	-20 (-28.9)
Y125GSS4GW	304 SS	2 1/2" - 12" (65mm - 300mm)	200 (13.79) ²	-20 (-28.9)
Y125FSS4BW / Y125FSS6BW	304 / 316 SS	2" - 12" (50mm - 300mm)	200 (13.79) ²	-20 (-28.9)
		14" - 24" (350mm - 600mm)	150 (10.34) ²	-20 (-28.9)
Y125FSS4LBW / Y125FSS6LBW	304L / 316L SS	2" - 12" (50mm - 300mm)	200 (13.79) ²	-20 (-28.9)
		14" - 24" (350mm - 600mm)	150 (10.34) ²	-20 (-28.9)
Y150FSBW	Carbon Steel	2" - 12" (50mm - 300mm)	285 (19.65) ³	-20 (-28.9)
Y150FSS4BW / Y150FSS6BW	304 / 316 SS	2" - 12" (50mm - 300mm)	275 (18.96) ³	-20 (-28.9)
Y150FSS4LBW / Y150FSS6LBW	304L / 316L SS	2" - 12" (50mm - 300mm)	230 (15.86) ³	-20 (-28.9)

- Notes:** 1. All strainers will be designed to the maximum design pressure unless an alternative design pressure / temperature combination is specified. In many cases a cost savings will result if lower design pressures are acceptable.
2. M.A.W.P. at 150°F.
3. M.A.W.P. at 100°F.

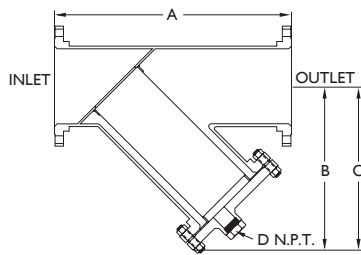

SERIES YI50F

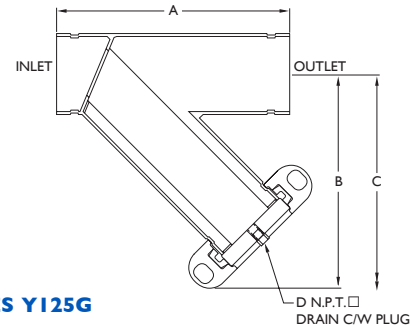

SERIES YI25G

Standard Screens

Flanged End		Grooved End	
Size Range	Opening	Size range	Opening
2" - 8" (50mm - 200mm)	0.125 in. (3.2mm)	2.5" - 5" (65mm - 125mm)	0.063 in. (1.5mm)
10" - 12" (250mm - 300mm)	0.125 in. (3.2mm)	6" - 8" (150mm - 200mm)	0.125 in. (3.2mm)
14" - 24" (350mm - 600mm)	0.188 in. (4.8mm)	10" - 12" (250mm - 300mm)	0.188 in. (4.8mm)

Dimensional Data

Size in. (mm)	A in. (mm)		B in. (mm)		C in. (mm)		D in. (mm)		Weight Lb. (kg)					
	Flanged	Grooved	Flanged	Grooved	Flanged	Grooved	Flanged	Grooved	Cover		Unit			
End type	Flanged	Grooved	Flanged	Grooved	Flanged	Grooved	Flanged	Grooved	Flanged	Grooved	Flanged	Grooved	Flanged	Grooved
2" 50	10.81 275	-	8.25 210	-	13.25 337	-	1/2 15	-	5 2	-	28 13	-	-	-
2 1/2" 65	13.38 340	9.5 241	10.25 260	8.81 224	16.44 418	14.06 357	1 25	1/2 15	9 4	1 0.45	81 37	21 10	-	-
3" 80	13.38 340	9.63 244	10.25 260	9.25 235	16.44 418	14.75 375	1 25	1/2 15	9 4	1.2 0.54	81 37	26 12	-	-
4" 100	14.75 375	11.63 295	10.50 267	11.25 286	16.75 425	18.50 470	1 1/2 40	1/2 15	17 8	2.5 1.13	85 39	33 15	-	-
5" 125	17.25 438	15.13 384	12.50 318	13.25 337	20.00 508	21.00 533	1 1/2 40	1/2 15	20 9	4.6 2.08	110 50	46 21	-	-
6" 150	22.00 559	18.00 457	14.00 356	15.81 402	22.44 570	25.75 654	2 50	3/4 20	26 12	1.6 0.72	145 66	70 32	-	-
8" 200	24.00 610	21.13 537	17.75 451	19.63 499	28.44 722	32.31 821	2 50	3/4 20	45 20	3.1 6	256 116	91 41	-	-
10" 250	31.50 800	25.50 648	22.00 559	24.69 627	35.25 895	41.00 1041	2 50	3/4 20	70 32	4.6 2	380 172	134 61	-	-
12" 300	32.75 832	29.38 746	25.00 635	27.88 708	40.00 1016	47.00 1194	2 50	3/4 20	110 50	36 16	700 317	225 102	-	-
14" 350	39.75 1010	-	27.00 686	-	43.25 1099	-	2 50	-	140 63	-	750 340	-	-	-
16" 400	45.25 1149	-	30.88 784	-	49.50 1257	-	2 50	-	180 82	-	905 410	-	-	-
18" 450	48.50 1232	-	33.88 861	-	54.25 1378	-	2 50	-	220 100	-	1125 510	-	-	-
20" 500	53.75 1365	-	39.00 991	-	62.50 1588	-	2 50	-	285 129	-	1415 641	-	-	-
24" 600	64.00 1626	-	44.00 1118	-	70.50 1791	-	2 50	-	430 195	-	1825 827	-	-	-

Notes: 1. Differentials are optional.

2. Butt weld dimensions are same as flanged.

General:

1. For further optional features see pages 21-22.

2. Other perforations and screen materials available. Please see page 24.

3. For pressure loss information see page 25.

4. For ordering information please see page 38.

5. Dimensions shown are subject to change.

Contact factory for certified prints when required.